

# Display $\Sigma$ LOW

19 September to 12 December 2015

# List of works

⑧  
HAIM STEINBACH  
' $\Sigma$ ' (1994)  
Black vinyl  
Dimensions variable

①  
CHARLOTTE CULLINAN  
AND JEANINE RICHARDS  
'Abstract Mirror Paintings'  
(2015)  
Mirrored vinyl, plastic,  
steel scaffolding,  
industrial paint

②  
AMALIA PICA  
'Stage (as seen in Afgan  
Star)' (2011)  
Cardboard, wood, tape,  
spotlight  
54 x 279.4 x 279.4 cm  
Exhibition copy, courtesy  
Coleccion Patricia Puellos  
de Cisneros

③  
NATHALIE DU PASQUIER  
'Painting with no title'  
(2013)  
Oil on canvas  
100 x 100 cm

④  
CÉLINE CONDORELLI  
'After Image (Gray and  
Bayer)' (2015)  
190 x 275 x 0.3 cm  
Aluminum screen parts, cut  
vinyl on existing window,  
wall painting

⑥  
CHRISTOPHER WILLIAMS  
TecTake Luxus Strandkorb grau/weiß  
Model no.: 400636  
Wood/plastic  
154 cm x 116 cm x 77 cm  
Weight: 49 kg  
Manufactured by Ningbo Jin Mao Import  
& Export Co., Ltd, Ningbo, Zhejiang,  
China for TecTake GmbH, Igersheim,  
Germany  
Model: Zimra Geurts, Playboy  
Netherlands Playmate of the Year 2012  
Studio Rhein Verlag, Düsseldorf,  
January 31, 2013  
(Zimra resting) (2013)  
Selenium toned gelatin silver print  
86 x 94.6 x 3.8 cm  
Edition 7 of 10, 4 AP  
Certificate of Authenticity  
WILCH0387

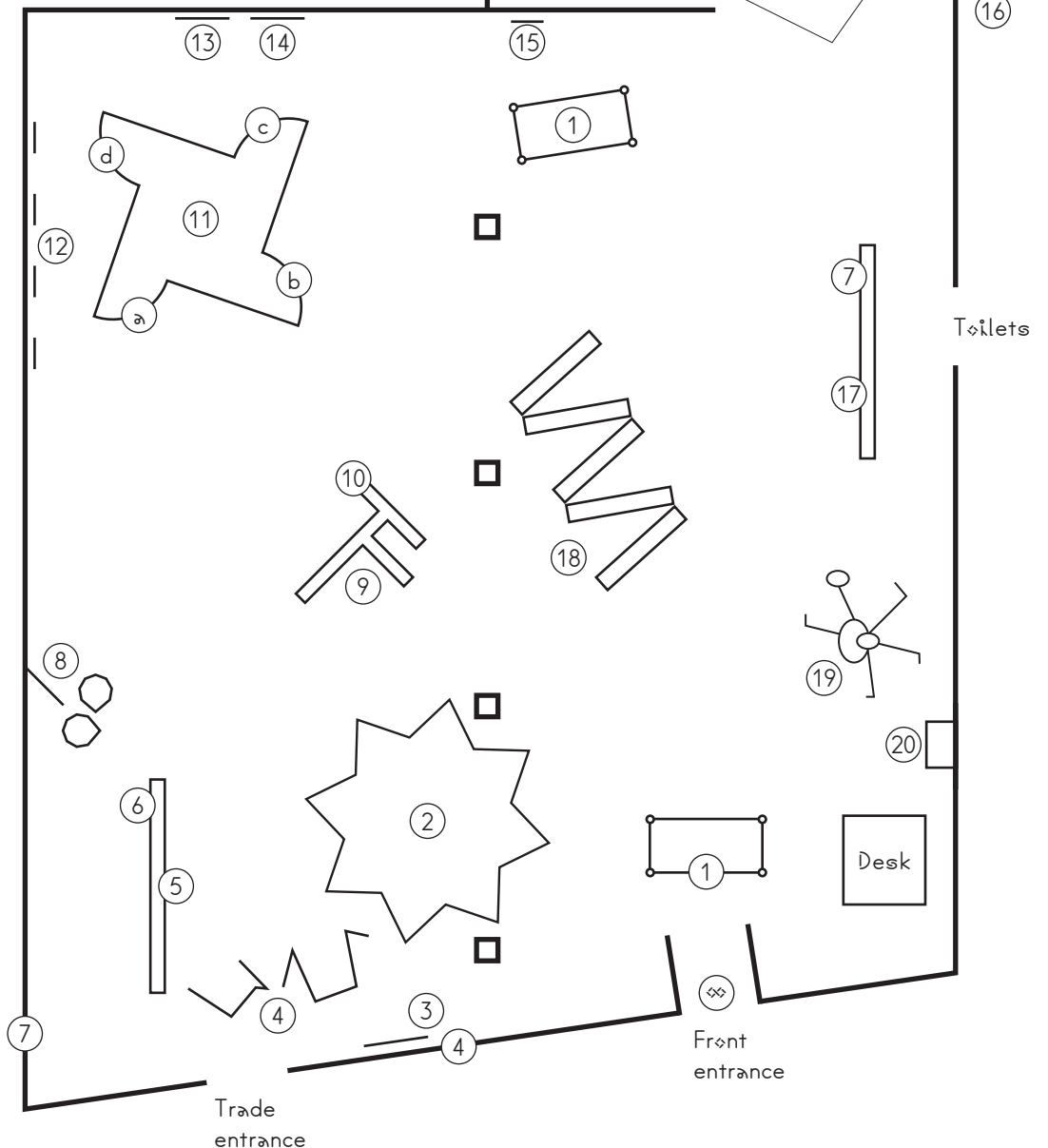
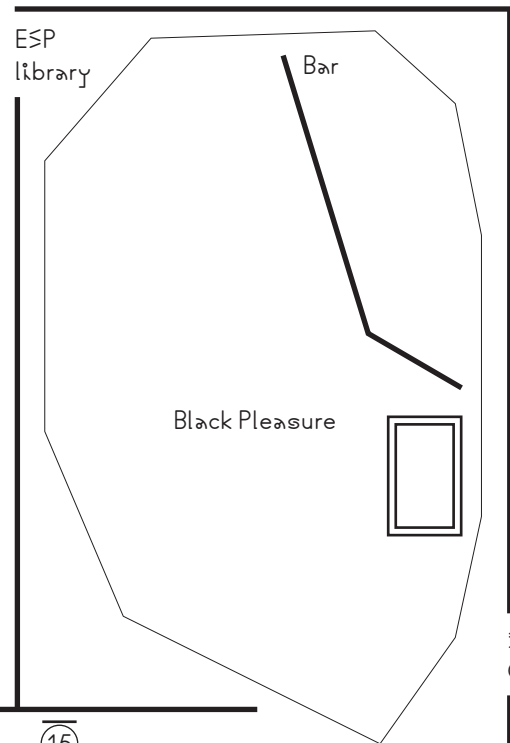

⑦  
PETER NENCINI AND JAMES LANGDON  
'Make Do Mutations' (2015)  
Printed paper

⑧  
RITA MCBRIDE  
McBride, Rita, and David Frazier Gray,  
eds. 'My ways', Vancouver: Arsenal  
Pulp Press (2006); McBride, Rita, and  
Erin Cosgrove, eds. 'Heartways: The  
Exploits of Genny O', Vancouver:  
Arsenal Advance (2004); McBride, Rita,  
and Glen Rubsamen, eds. 'Future ways',  
Vancouver: Arsenal Advance (2004);  
McBride, Rita, and Matthew Liclt,  
eds. 'Crime ways', Vancouver: Arsenal  
Pulp Press (2005); McBride, Rita, and  
Matthew Liclt, eds. 'West Ways',  
Zurich: JRP/Ringier (2010), displayed  
on Martin Gampfer 'Untitled' (2010),  
hinged book display system, small  
blue panel, adjustable shelves in laser  
cut, powder coated steel

⑨  
GAVIN WADE  
'T-Type Display Unit (After Kiesler  
and Krischanitz)' (2015)  
8 powder coated aluminium components  
in 6 colours, lard wood slatted panel,  
steel bolts  
300 x 60 x 5cm

⑩  
LEEDS WEIRDO CLUB  
'Derivation Army' (2015)  
Doug Bowen, Matthew Crawley, Harry  
Meadley, David Steans  
Custom-made suit  
Dimensions variable

⑪  
GOSHKA MACUGA  
'Kabinett der Abstrakten (After El  
Lissitzky)' (2003)  
MDF, oak veneer, lacquer  
200 x 200 x 200cm  
Arts Council England Collection

Displaying works by:

a – Nicole Wermers, Simon & Tom  
Blair, Joanne Tatlam & Tom O'Sullivan,  
Lesley Whitelead

b – Rutl Claxton, Joanne Tatlam & Tom  
O'Sullivan, Herbert Bayer, Flore Nové-  
Jossierand, various publications

c – Heutler & Ivan Morrison, Frederick  
Kiesler, Rutl Claxton, Joanne Tatlam &  
Tom O'Sullivan

d – Flore Nové-Jossierand, Nicole  
Wermers

⑫  
NICOLE WERMERS  
'Carpets and Glass #4 #6 #7 #8 #9  
#10' (2012)  
6 C-type print, stainless steel clips,  
clip frame  
50 x 40 cm

⑬  
NATHALIE DU PASQUIER  
'Painting with no title' (2012)  
Oil on canvas  
100 x 100 cm

⑭  
NATHALIE DU PASQUIER  
'Painting with no title' (2008)  
Oil on canvas  
100 x 100 cm

⑮  
EILIS MCDONALD  
'Numerous Objects' (2010–2015)  
Digital image collection, code

⑯  
FLORE NOVÉ-JOSSERAND  
City Growth Blues (2015)

⑰  
CHRISTOPHER WILLIAMS  
Garten in Vögtmichlefeld,  
Alpirsbach, June 7, 2010 (2010)  
Archival pigment print on cotton rag  
paper  
83.2 x 94 x 3.8 cm  
Edition 3 of 10, 4 AP  
Certificate of Authenticity  
WILCH0329

⑱  
YELENA POPOVA  
'Cornelius: The Collectors Case'  
(2015)  
Custom flight case, seven aluminium  
frames, ten paintings, mixed medium  
on linen, each 75 x 55cm, from RCA  
Series (2011)

⑲  
CÉLINE CONDORELLI  
'Sündelien' (2015)  
Corpor pipe, fan, light, lightboard,  
speaker, mp3 player and track, C-type  
prints, 65 x 65 x 210cm

'The Strategy of Everything' (2015)  
Silkscreen print, daily newspaper  
(Claridad, 22/01/2015), 30 x 35 cm

⑳  
HAIM STEINBACH  
'Untitled (Atlas)' (2013)  
Fibreglass-faced honeycomb boards,  
plastic laminate and glass box; silver  
sculpture  
68.1 x 58.1 x 26.9 cm

㉑  
LEEDS WEIRDO CLUB  
'Gently Used' (2015)  
Doug Bowen, Matthew Crawley, Harry  
Meadley, David Steans  
Custom-made mascot suit  
Dimensions variable